

EW AC

EW

Saldatrici rotanti a corrente alternata a 2 poli senza spazzole.

- > Protezione: IP23
- > Tipo di elettrodi saldabili: rutile
- > Fornita di protezione termica autoripristinabile contro i sovraccarichi
- > Utilizzabile anche come alternatore monofase
- > Forme costruttive: IM B34 - B3/B14, IM B35 B3/B9, IM B35 - J609a, IM B35 - J609b, SAE 5, SAE 6*

2 poles brushless alternating-current rotating welders.

- > Protection: IP23
- > Weldable electrodes: rutile
- > Supplied with autoresettable thermal breaker against overload
- > Can also be used as single phase alternator
- > Shape: IM B34 - B3/B14, IM B35 B3/B9, IM B35 - J609a, IM B35 - J609b, SAE 5, SAE 6*

* SAE 6 disponibile solo su richiesta • SAE 6 available on request

Saldatrice • Welder

modello model	velocità speed	peso IMB35 weight IMB35	corrente di saldatura welding current	tensione di innesco strike voltage	tensione di saldatura welding voltage	servizio duty	potenza assorbita driving rating
	rpm	Kg	A	V	V		
EW130 AC/2	3000	32	60 ÷ 130	50 ÷ 62,5	22,4 ÷ 25,2	130 A • 35% 1ph	6.0 kW • 8.5 Hp
EW180 AC/2	3000	37	60 ÷ 135 / 90 ÷ 180	50 ÷ 62,5	22,4 ÷ 25,4 / 23,6 ÷ 27,2	180 A • 35% / 125 A • 60% 1ph	8.0 kW • 11.0 Hp
EW200 AC/2	3000	42	60 ÷ 135 / 120 ÷ 200	45 ÷ 60	22,4 ÷ 25,4 / 24,8 ÷ 28	200 A • 35% / 180 A • 60% 1ph	9.0 kW • 12.0 Hp
EW140 AC/2	3600	32	60 ÷ 140	50 ÷ 62,5	22,4 ÷ 25,6	140 A • 35% 1ph	6.5 kW • 9.0 Hp
EW190 AC/2	3600	37	60 ÷ 135 / 100 ÷ 190	47,5 ÷ 60	22,4 ÷ 25,4 / 24 ÷ 27,6	190 A • 35% / 135 A • 60% 1ph	9.0 kW • 12.0 Hp
EW220 AC/2	3600	42	60 ÷ 135 / 120 ÷ 220	45 ÷ 60	22,4 ÷ 25,4 / 24,8 ÷ 28,8	220 A • 35% / 180 A • 60% 1ph	9.5 kW • 13.0 Hp

Alternatore • Alternator

modello model	velocità speed	potenza power	tensione regolabile voltage adjustable	corrente (max S1) current (max S1)	frequenza frequency
	rpm	(S1) kVA	A	A	
EW130 AC/2	3000	4	115 / 230	17,4	50
EW180 AC/2	3000	5	115 / 230	21,7	50
EW200 AC/2	3000	7	115 / 230	30,4	50
EW140 AC/2	3600	5	110 / 220	21,7	60
EW190 AC/2	3600	6	110 / 220	26,1	60
EW220 AC/2	3600	8	110 / 220	34,7	60

dimensioni di ingombro overall dimensions

	A	B	C	D	A1	B1	C1	D1
	IM B34 - IM B 35 (J609a), IM B35 (c.23-c.30)				IM B35 - J609b			
EW130 AC/2	365	69	315	283	381	85	331	283
EW180 AC/2	365	69	315	283	381	85	331	283
EW200 AC/2	420	124	370	338	436	140	386	338
EW140 AC/2	365	69	315	283	381	85	331	283
EW190 AC/2	365	69	315	283	381	85	331	283
EW220 AC/2	420	124	370	338	436	140	386	338

IM B34 - B3/B14

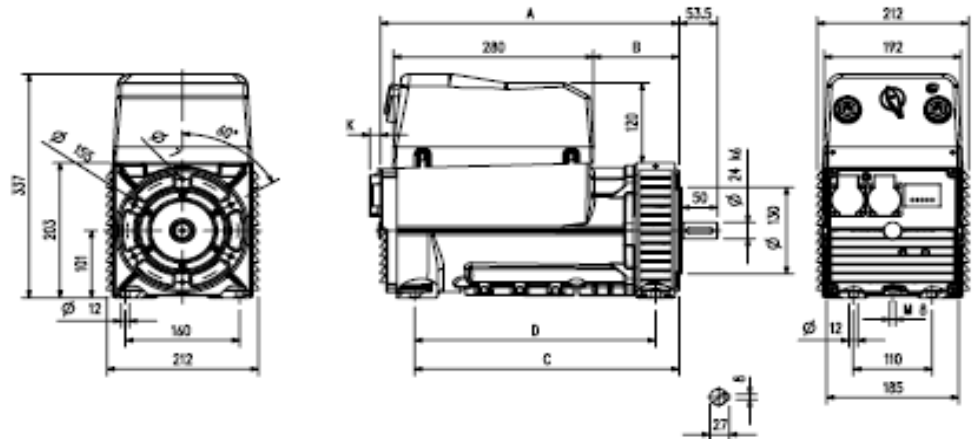

IM B35 - J609b

cono - cone	albero / shaft		
	d	a	b
22,14	22,14	81	32
25,4	25,4	63,5	49,5
35	30	39	72

	K
prese Schuko / Schuko sockets	16
prese CEE / CEE sockets	47

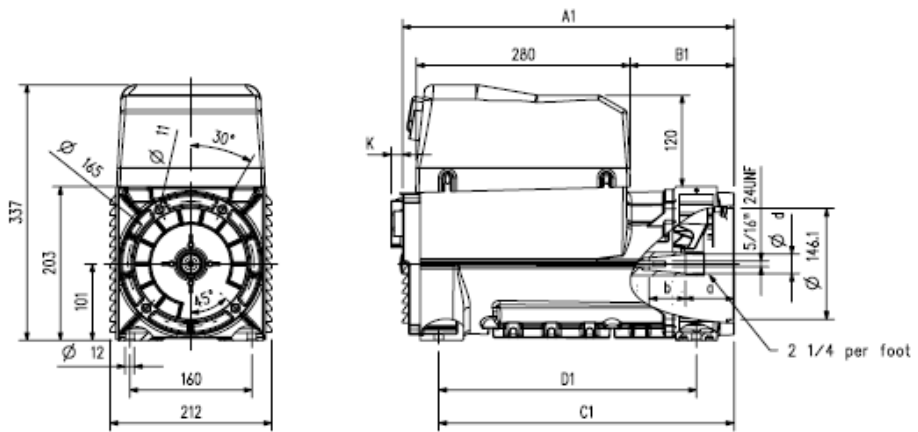

SAE 5

tipo - type	da / from	dimensioni / dimensions			
		A'	B	C	D
EW 130-180	IM35 C.30	377	81	327	283
EW 140-190	IM35 C.30	377	81	327	283
EW 200	IM35 C.30	432	136	382	338
EW 130-180	IM35 J609b C.35	393	97	343	283
EW 140-190	IM35 J609b C.35	393	97	343	283
EW 200	IM35 J609b C.35	448	152	398	338

giunto a dischi / disk joint	L	d	l	N fori / N holes	J	S
6,5	30,2	215,9	200	6	9	60°
7,5	30,2	241,3	222,2	8	9	45°

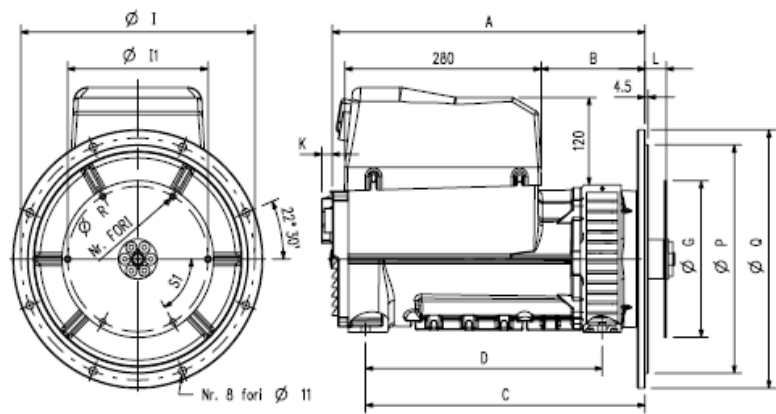

IM B35-J609a

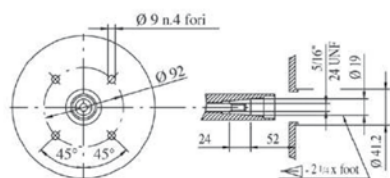

IM B35-B3/B9

albero / shaft			
d	a	b	M
23	8	30	M8
30	16	30	M14

